

GC2512

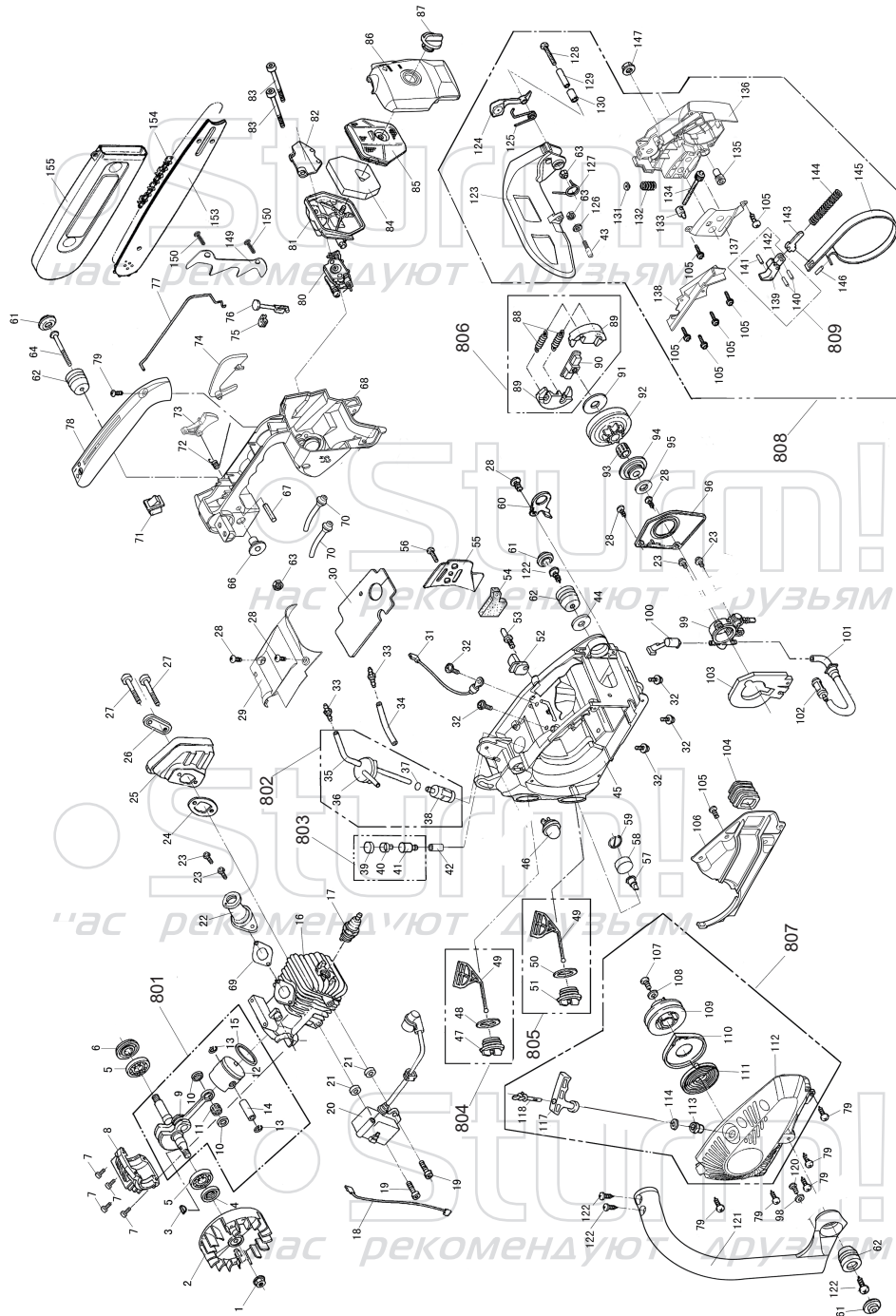

NO.	DESCRIPTION	NO.	DESCRIPTION	NO.	DESCRIPTION
1	NUT M8x1	56	SCREW ST4.2x11	111	STARTER SPRING
2	FLYWHEEL-ASSY	57	BREATH NIPPLE	112	STARTER HOUSING
3	WOODRUFF KEY3x10	58	BREATH NIPPLE COVER	113	ROPE JACKET
4	SMALL OIL SEAL 12x22x4.5	59	BREATH NIPPLE SPRING	114	WASHER-STARTER HANDLE
5	BALL BEARING 6001Z	60	POTHOOK	117	STARTER HANDLE
6	BIG OIL SEAL 12x28x6	61	RUBBER PAD COVER	118	STARTER ROPE
7	SCREW M5x20	62	PAD	120	SCREW ST3.5x10
8	CRANKCASE BEARING SUPPORT	63	NUT M5	121	HANDLE ASST
9	CRANK SHAFT ASSY	64	SCREW M5x45	122	SCREW ST4.8x16
10	NEEDLE BEARING SNAP			123	FRONT GUARD
11	NEEDLE BEARING	66	COVER CAP	124	LEVERAGE
12	PISTON	67	TRIGGER PIN 5x26	125	LEVERAGE SPRING
13	PIN CIRCLIP	68	HANDLE	126	SPRING WASHER
14	PISTON PIN	69	INTAKE GASKET	127	BRAKE SPRING
15	PISTON RING	70	CARBURATOR PIPE	128	SCREW M5x30
16	CYLINDER	71	SWITCH STOP	129	BUSHING
17	SPARK PLUG	72	TRIGGER SPRING	130	LEVERAGE PIN
18	FLAMEOUT WIRE	73	TRIGGER	131	BRAKE SPRING SUPPORT
19	SCREW M4x20	74	TRIGGER LEVER	132	FORNT GUARD SPRING
20	ELECTRON IGNITION ASSY	75	CHOKE KNOB GROMMET	133	CHAIN ADJUSTING PIN
21	PAPER GASKET	76	CHOKE KNOB	134	CHAIN ADJUSTING SPROCKET
22	INTAKE HOSE	77	ROD THROTTLE	135	CHAIN ADJUSTING SCREW
23	SCREW M4x14	78	REAR HANDLE COVER	136	RIGHT COVER
24	MUFFLER WASHER	79	SCRW ST4.2x16	137	CHAIN ADJUSTING COVER
25	MUFFLER ASSY	80	CHINESE CARBURATOR ASSY	138	SPRING BRAKE COVER
26	MUFFLER COVER	81	AIR FILTER SUPPORT	139	MAIN LEVER
27	SCREW M5x40	82	AIR FILTER COVER	140	SHORT PIN
28	SCREW ST4.2x13	83	SCREW M5x45	141	LONG PIN
29	TOP COVER	84	AIR FILTER SPONGE	142	AUXILIARY LEVER
30	PAPER GASKET	85	AIR FILTER SPONGE COVER	143	BREAK LEVEL
31	GROUND WIRE	86	AIR FILTER COVER	144	BRAKE SPRING
32	SCREW M5x16	87	AIR FILTER KNOB	145	BAND BRAKE
33	HOSE ADAPTER	88	CLUTCH SPRING	146	PIN
34	OIL RETURN PIPE	89	CLUTCH SUPPORT	147	BAR NUT
35	FUEL HOSE	90	CLUTCH RETAINER	149	SPIKE
36	FUEL HOSE SUPPORT	91	CLUTCH WASHER	150	SCREW ST4.8x14
37	CONNECT PIPE CLIP	92	CLUTCH DRUM	153	GUIDE BAR
38	FUEL FILTER	93	CLUTCH NEEDLE BEARING	154	CHAIN
39	BALANCE COVER	94	WORM	155	BAR PROTECTOR
40	BALANCE BODY	95	OIL PUMP WASHER	801	CRANK SHAFT AND PISTON ASSY
41	BALANCE HOUSING	96	OIL PUMP COVER	802	FUEL FILTER ASSY
42	BALANCE CONNECTOR	99	OIL PUMP ASSY	803	BALANCE ASSY
43	PIN	100	FUEL INJECTION NOZZLE	804	FUEL CAP ASSY
45	FUEL TANK	101	OIL INLET HOSE	805	OIL CAP ASSY
46	PRIMER BULB	102	OIL FILTER	806	CLUTCH ASSY
47	FUEL CAP	103	DUSTPROOF SPONGE	807	STARTER ASSY
48	FUEL CAP WASHER	104	AIR INTAKE SUPPORT	808	BRAKE ASSY
49	OIL CAP HOLDING	105	SCREW ST4.2x8.5	809	MAIN AND AUXILIARY LEVER ASSY
50	OIL CAP WASHER	106	FAN BAFFLE		
51	OIL CAP	107	SCREW ST4.8x16		
52	CHAIN CATCHER	108	WASHER φ5x15x1.5		
53	SCREW	109	PULLEY STARTER		
54	BAR PLATE SPONGE	110	SPRING COVER		
55	BAR PLATE				